



SLPD 20/20-64/32 DIN is a series of in-line dual flow pumps with extremely low noise levels for demanding mobile hydraulics.

SLPD 20/20-64/32 DIN comes in eight different sizes, where three models feature differentiated flows. Pumps with differentiated flow increase the field of application as they can provide three different flows: one small, one large and one combined flow. Maximum pressure is 330-350 bar depending on the model. Its slim pump housing makes direct mounting on the power take-off possible in very confined areas. SLPD 20/20-64/32 DIN is also ideal for installation using a frame bracket via an intermediate shaft.

It is available in a version with a Savtec valve for applications where the hydraulics need to be used while the vehicle is on the move.

Other advantages:

- Independent direction of rotation
- A cost effective total solution in relation to a conventional installation using two pumps with a splitter gear box
- Smooth operation over the entire speed range
- Long life due to high demands on material selection, such as bearings, seals, etc.
- O-rings on all contact surfaces as well as double shaft seals
- Extremely low noise emission over entire speed and pressure ranges

Versions, main data

Example

| | | | | | | | | | | | | | |
|-----------|-----------|---|--------------|----------|---|----------|---|------------|---|------------|---|-----------|----------|
| SL | PD | - | 46/46 | W | - | N | - | DL4 | - | L35 | - | S4 | S |
| Line | 1 | | 2 | 3 | | 4 | | 5 | | 6 | | 7 | 8 |

Line

| | |
|----|----------------|
| SL | Sunfab In-Line |
|----|----------------|

1. Type

| | |
|----|----------------|
| PD | Dual flow pump |
|----|----------------|

2. Displacement

| |
|---|
| 20/20 28/28 40/20 35/35 56/28 46/46 53/53 64/32 |
|---|

3. Direction of rotation

| | |
|---|-------------|
| W | Independent |
|---|-------------|

4. Sealing

| | |
|---|---------|
| N | Nitrile |
|---|---------|

5. Mounting flange

| | |
|-----|---------------------|
| DL4 | DIN 4-h (ISO 7653D) |
|-----|---------------------|

6. Shaft

| | |
|-----|-------------------|
| L35 | DIN 5462 / ISO 14 |
|-----|-------------------|

7. Connection cover

| | |
|----|----------------------|
| S4 | Sunfab standard SLPD |
|----|----------------------|

8. Connections

| | |
|---|-----------------|
| S | Sunfab standard |
|---|-----------------|

X = Standard, preferred

(X) = Available, option

O = Contact Sunfab

| Pump SLPD 20/20-64/32 DIN | | 20/20 | 28/28 | 40/20 | 35/35 | 56/28 | 46/46 | 53/53 | 64/32 | |
|------------------------------------|----------------------|------------|-------------|-------------|-------------|-------------|-------------|-------------|-------------|------------|
| Theoretical oil flow at pump speed | rpm | 500 | 10.1 +10.1 | 13.7 +13.7 | 20.3 +10.1 | 16.9 +16.9 | 27.4 +13.7 | 22.9 +22.9 | 26.2 +26.2 | 31.5 +15.7 |
| | | 1000 | 20.3 +20.3 | 27.5 +27.5 | 40.7 +20.3 | 33.9 +33.9 | 54.9 +27.5 | 45.8 +45.8 | 52.5 +52.5 | 63 + 31.5 |
| | | 1500 | 30.4 +30.4 | 41.3 +41.3 | 61.0 +30.4 | 50.8 +50.8 | 82.3 +41.2 | 68.7 +68.7 | 78.7 +78.7 | 94.5 +47.2 |
| Displacement | cm ³ /rev | 20.3 +20.3 | 27.5 + 27.5 | 40.7 + 20.3 | 33.9 + 33.9 | 54.9 + 27.5 | 45.8 + 45.8 | 52.5 + 52.5 | 63.0 + 31.5 | |
| Max pump speed | rpm | 2200 | 1800 | 2200 | 2200 | 1800 | 1800 | 1600 | 1600 | |
| Max working pressure | bar | 350 | 350 | 350 | 330 | 350 | 330 | 330 | 350 | |
| Weight | kg | 22.0 | 22.0 | 22.0 | 22.0 | 22.0 | 22.0 | 22.0 | 22.0 | |
| Dimensions | mm | A | 133 | 133 | 133 | 133 | 166 | 166 | 166 | |
| Min. dimensions | B | 50 | 50 | 50 | 50 | 64 | 64 | 64 | 64 | |
| Tare-weight torque (M) | Nm | 26.5 | 26.5 | 26.5 | 26.5 | 26.5 | 26.5 | 26.5 | 26.5 | |
| Direction of rotation | Independent | | | | | | | | | |

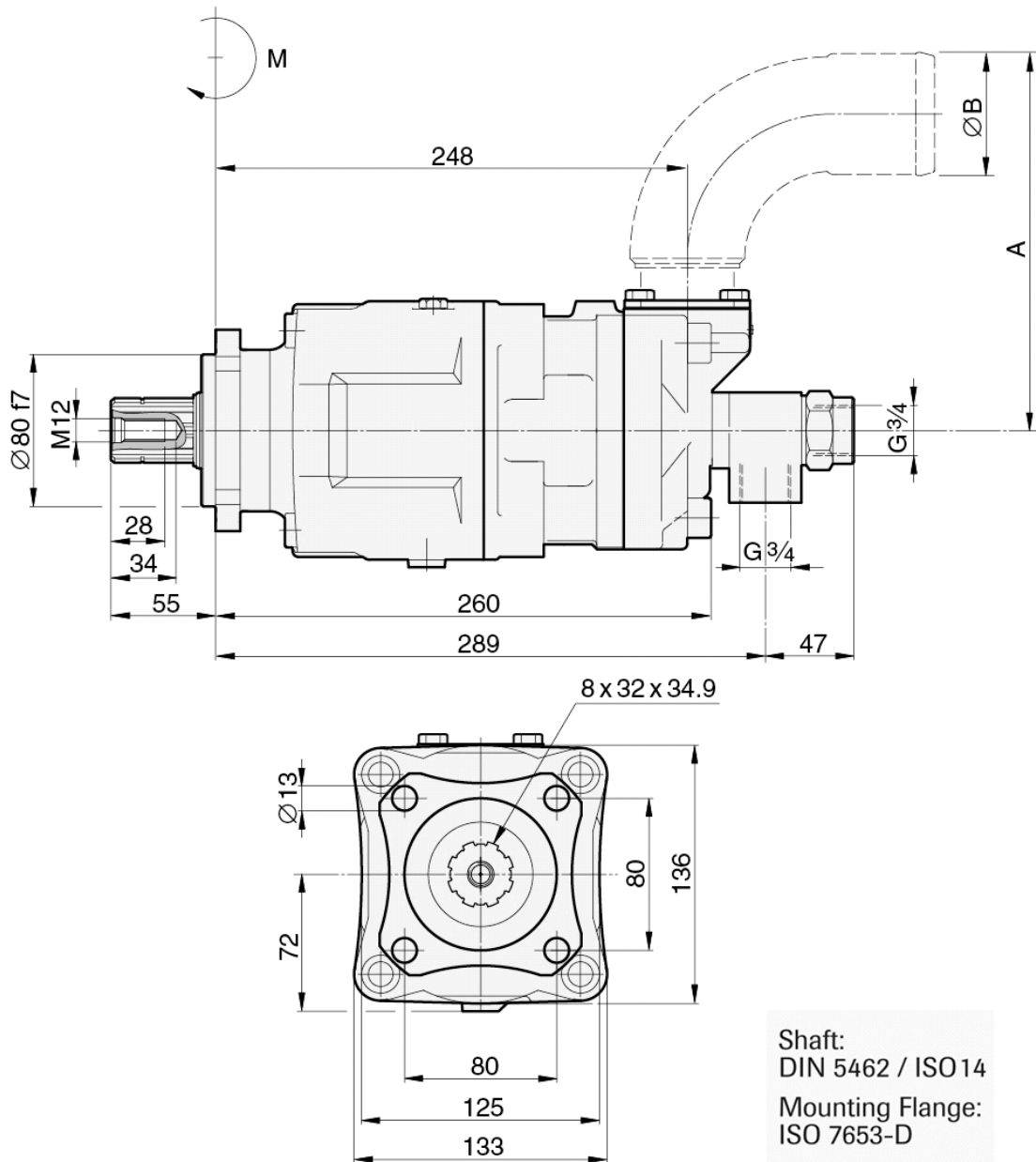



WARNING

When the pump is running:

1. Do not touch the pressure hose
2. Watch out for rotating parts
3. The pump and hoses may be hot

*Sunfab reserves the right to make changes in design and dimensions without notice. Printing and typesetting errors reserved.
© Copyright 2015 Sunfab Hydraulics AB. All Rights Reserved.*